

# POW'R/CRANK OB BRACKETS INSTALLATION INSTRUCTIONS

Read these instructions completely before beginning installation. If you have any questions regarding installation, please call

**pow'rtran**  
at 1-800-466-7697.

**IMPORTANT:** The Pow'r OB Bracket will provide up to a 16 inch vertical lift and is rated to a maximum 20 HP motor. The Crank OB Bracket will provide up to a 14 inch vertical lift and is rated to a maximum 20 HP motor. Installation or use on motors in excess of these specifications nullifies all stated or implied warranties. Not recommended for use with four stroke engines.

**CAUTION:** Do not continue to depress control switch when unit is in the fully extended or retracted position – damage to the plastic acme nut may result. This is not covered under warranty.

Congratulations on your purchase of the Pow'r/Crank OB Bracket. When properly installed, it will provide back-saving, trouble-free lift for your kicker or auxiliary motor for many years.

#### MATERIALS YOU WILL NEED:

- Two 9/16" wrenches
- One phillips screwdriver
- One 3/8" drill bit
- One tube of clear RTV silicone.
- Drill

#### FOR CRANK OB SKIP TO STEP 3

**STEP 1:** In order to measure clearance, connect the control box and switch to the actuator and

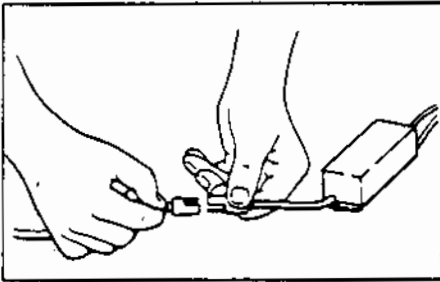

Apply corrosion protective grease (not supplied) to the wiring harness plug. Connect the 2-wire actuator motor cord to the 2-wire plug from the control box.

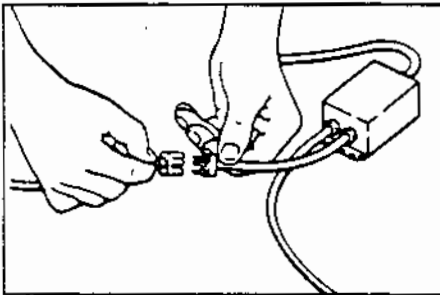

Apply corrosion protective grease (not supplied) to the 3-wire control switch plug. Connect this 3-wire control switch plug to the 3-wire plug from the control box.

**STEP 2:** For measuring purposes, hook up the control box to your 12V battery. Red wire goes to positive, black to negative terminals. Press switch and raise the mounting board to the top of its extension - 16 inches. Make sure your fingers are clear during the lift process. This will position actuator in fully upward, extended position. Disconnect the unit from battery until outboard motor is mounted and control box and switch have been reconnected.

**STEP 3:** To select the proper location for mounting the Pow'r/Crank OB Bracket, hold the bracket up to the transom to determine the best mounting area. Make sure that the propeller is at the proper depth and that there is clearance for tilting and turning the motor.

**STEP 4:** Using the mounting bracket as the template, mark all four holes. Drill for 3/8" mounting

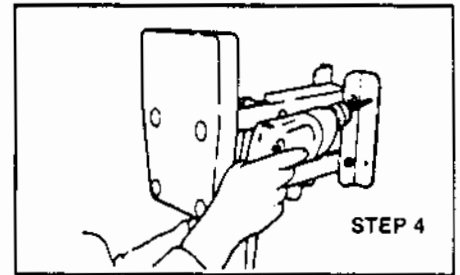

**STEP 5:** Apply RTV Silicone around each mounting hole on the outside of the transom.

**STEP 6:** Bolt mounting bracket to the transom, using the 3/8" x 3-1/2" bolts provided. Install large washers and lock nuts inside the transom. Tighten securely.

**STEP 7:** Mount the outboard motor to the mounting board, making sure the clamps fit tightly. We recommend installing a safety chain to your motor.

**STEP 8: (Crank Unit Only)** To use ratchet, brace, or electric drill, remove roll pin from hand crank.

**Important:** Use the supplied outboard security strap when trailering your boat, with motor on OB Bracket. See mounting and use instructions in strap kit.

## The Pow'rTran Warranty Program **PB 100**

Thank you for choosing a Pow'rTran product. This quality unit is covered by the following limited warranty.

For a two (2) full years after date of purchase, your Pow'rTran unit is warranted to operate properly under conditions of normal use. This warranty includes all electrical and mechanical components.

If the unit fails to operate properly during the first two years after purchase, call Pow'rTran so appropriate and satisfactory action may be taken. If a return is required, a company representative will provide you with information to facilitate the return.

Repair or replacement will be made and the repaired or new unit shipped back to you via prepaid freight, usually within ten (10) days of receipt. **Proof of purchase must be provided for all warranty claims.**

This warranty does not cover damage due to rust, corrosion, accident, or abuse of the unit.

This is the only warranty and all other warranties, including implied warranties of merchantability or fitness for a particular purpose, are disclaimed. Some states do not allow limitation on how long an implied warranty lasts, so the above limitation may not apply to you. This warranty does not cover any incidental or consequential damages. Some states do not allow the exclusion or limitation of incidental or consequential damages, so the above limitations may not apply to you.

This warranty applies only if the unit is installed pursuant to instructions and the unit is not subject to damage, other

than that which may occur in ordinary use, such as collision from the rear, fire, explosion, vandalism or sinking. Warranties are valid only if serviced by the factory.

## The Pow'rTran Warranty Program **PB 120**

Thank you for choosing a Pow'rTran product. This quality unit is covered by the following limited warranty.

For one (1) year after date of purchase, your Pow'rTran unit is warranted to operate properly under conditions of normal use. This warranty includes all electrical and mechanical components.

If the unit fails to operate properly during the first year after purchase, call Pow'rTran so appropriate and satisfactory action may be taken. If a return is required, a Pow'rTran representative will provide you with information to facilitate the return.

Repair or replacement will be made and the repaired or new unit shipped back to you via prepaid freight, usually within ten (10) days of receipt. **Proof of purchase must be provided for all warranty claims.**

This warranty does not cover damage due to rust, corrosion, accident, or abuse of the unit.

This is the only warranty and all other warranties, including implied warranties of merchantability or fitness for a particular purpose, are disclaimed. Some states do not allow limitation on how long an implied warranty lasts, so the above limitation may not apply to you. This warranty does not cover any incidental or consequential damages. Some states do not allow the exclusion or limitation of incidental or consequential damages, so the above limitations may not apply to you.

This warranty applies only if the unit is installed pursuant to instructions and the unit is not subject to damage, other

than that which may occur in ordinary use, such as collision from the rear, fire, explosion, vandalism or sinking. Warranties are valid only if serviced by the factory.